



**S.I. Storey**

LUMBER COMPANY, INC.

Since 1920



**CartGuard™**

*Designed to meet the needs of the golf and recreation industry, CartGuard™ provides golf course professionals and recreational planners an aesthetic solution for enhancing safety of cart paths or to restrict intrusion of carts and vehicles into sensitive areas.*



Osmose® Wood Products  
Licensed Manufacturer  
Since 1955

285 Sike Storey Rd. • P.O. Box 99  
Armuchee, GA 30105  
Phone: 888-934-1605 Fax: 706-235-8132

Southern Pine Inspection  
Bureau Member  
Since 1943

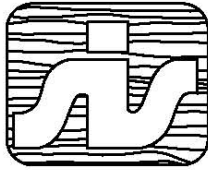

# S.I. Storey

LUMBER COMPANY, INC.

S.I. STOREY LUMBER CO., INC.  
285 SIKE STOREY RD NW  
P.O. BOX 99  
ARMUCHEE, GA 30105-0099  
TOLL FREE: (888) 934-1605  
PHONE: (706) 234-1605  
FAX: (706) 235-8132  
www.timbarrier.com

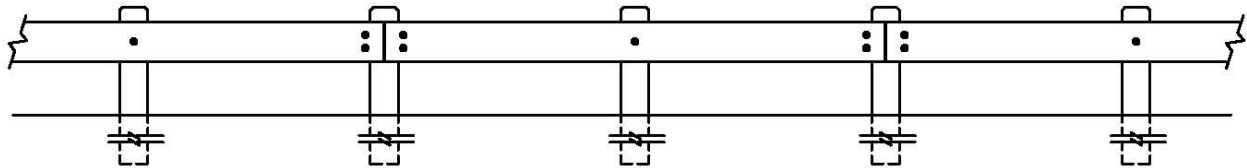
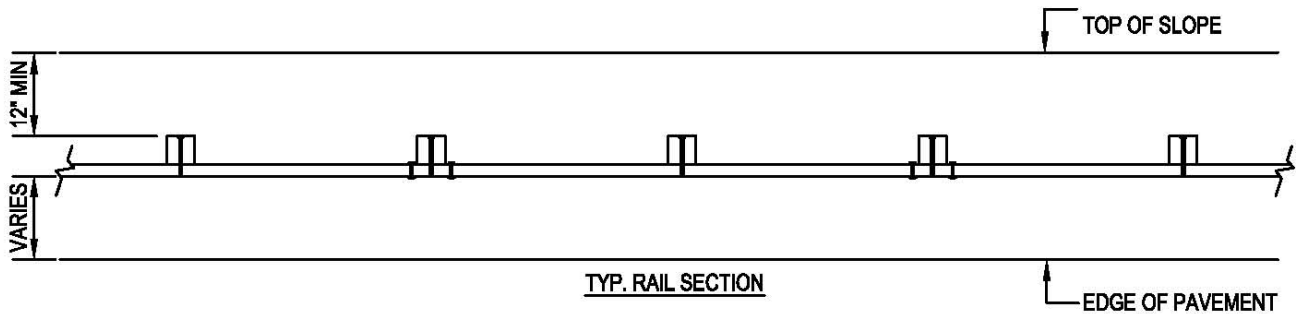

6' SPACING (TYPICAL)

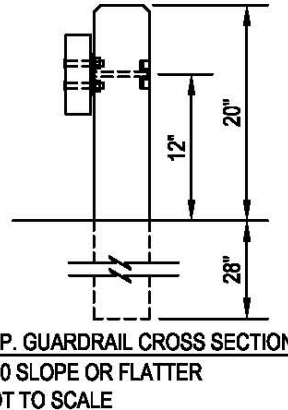
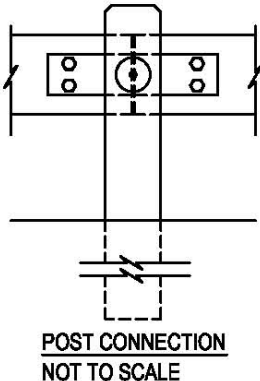

#### NOTES:

1. INSTALLATION TO BE COMPLETED IN ACCORDANCE WITH MANUFACTURER'S SPECIFICATIONS.
2. DO NOT SCALE DRAWINGS.
3. INCREASE POST LENGTH TO 5' IF BACK OF POST IS CLOSER THAN 12" TO TOP OF SLOPE OR WHEN LOCATED IN CLIMATES WHERE FROST HEAVING MAY OCCUR.
4. DRIVE POSTS OR AUGER, BACKFILL WITH NATIVE SOIL AND COMPACT EVERY 12".
5. ALL TIMBER #1 S4S SOUTHERN PINE, PRESSURE TREATED: AWP-C14, WOOD FOR USE IN HWY. CONSTR.
6. TYP. POST: 6" X 8" X 4' - TYP. RAIL: 3" X 8" X 11' 11 1/2"; FOR RADIUS SECTIONS SPECIFY 3" X 8" X 5' 11-1/2"
7. FASTENERS: ASTM A307; A242; F436 TYPE 3; A563 DH3.
8. TIMBARRIER™ SPLICE PLATE & PLATE WASHER ASTM-A588.
9. UNDER EACH BOLT HEAD ON FACE OF RAIL INSTALL ONE 7/8" WASHER.
10. REFER TO DRAWINGS 651-002b FOR TERMINAL DETAILS
11. CONTRACTORS NOTE: FOR PRODUCT AND COMPANY INFORMATION VISIT [www.CADdetails.com/info](http://www.CADdetails.com/info) REFERENCE NUMBER 651-002.

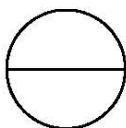

## TIMBARRIER™

CARTGUARD™, GOLF CART PATHWAY AND WALKWAY APPLICATIONS